



AEROKING AERATORS

For Sport & Pitch Aeration

PITCH PERFECT SOLUTIONS FROM R T MACHINERY

Solid Tines

x 300.50-300.80 Cod.	Ø xl mm.	Ø xl inc.	n. x	
7080818	8x180	8/16x7	4*-8***	
7081230	12x300	1/2x12	4	
7081830	18x300	3/4x12	2	
7082531	25x300	1x12	2	

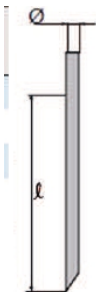

Hollow tines for coring

x 300.50-300.80 Cod.	Ø xl mm.	Ø xl inc.	n. x	
7071617	16x175	5/8x7	4	
7071925	19x255	3/4x10	2	
7072525	25x255	1x10	2	

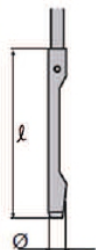

Adapters to be used with any tool with */**

Cod.	Ø mm.	Ø inc.	n. x	
7089000	12-8	1/2-5/16	4	
7086000	25-18	1-3/4	2	

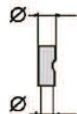

Multipliers to be used with every tools with */**

x 300.50-300.80 Cod.	Ø mm.	Ø inc.	n. x	
7141000	8	5/16	1	

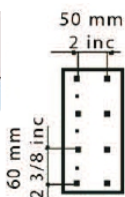

Serie 300.50

AEROKING DEEP VERTICAL AERATORS FOR COMPACT TRACTOR OPERATION ON SPORTS GROUNDS & SPORTS TURF



0,3 – 2,3 Km/h
0,2 – 1,5 miles/h

3p. Cat I - II

U 5/30 cm



Mod.	cm	HP min/max	KW min/max	N. 	kg
C 1204 J	120	20/50	14/36	4	510
C 1656 J	165	30/50	22/36	6	650

Max work capacity 3.800 mq/h



Standard on all models :

- *3 speed selectable lever gearbox
- *Protected pto shaft with clutch
- *Pre lubricated seals & bearings reducing maintenance & long life.
- *Rear Roller follow on turf press as standard.
- *Steel Guards with clamp fix easy access.
- *Multi Tine Heads for range of tine size / type

**Put the Punch into
Your Pitch Aeration**



AEROKING HD AERATORS

Available to Factory Order

Serie 300.80

**MEDIUM SIZE AERATORS
IDEAL FOR CONTRACTORS
TO INCREASE THE WORK
PERFORMANCE**



0,3 – 2,3 km/h
0,2 – 1,5 miles/h

3p. Cat I - II

U 5/30 cm



Mod.	↔ cm	HP min/max	KW min/max	N. ⬇	kg
C 1656 L	165	40/80	29/58	6	730
C 2108 L	210	50/80	36/58	8	800
C 2510 L	250	55/80	40/58	10	1050

Max work capacity 5,750 mq/h



Serie 400.90

**PROFESSIONAL AERATORS
FOR BIG DEPTHS**



0,4 – 2,9 km/h
0,25 – 1,8 miles/h

3p. Cat I - II

U 5/40 cm



Mod.	↔ cm	HP min/max	KW min/max	N. ⬇	kg
C 1706 N	170	45/95	33/70	6	930
C 2108 N	210	55/95	40/70	8	1160
C 2510 N	250	70/95	51/70	10	1380

Max work capacity 5,250 mq/h

