

# ETESIA

GB

Original user  
manual

Please read carefully before using your machine



**AK60 - AH75**

# CONTENTS

1• Your safety and that of others .....	3
2• Key to diagrams .....	5
3• Description .....	7
4• Pictures.....	8
5• Technical specifications .....	13
6• Preparation and getting started.....	14
7• Operating instructions .....	15
8• Maintenance.....	16
9• Long stop - Winter storage .....	19
10• Regular maintenance summary .....	20
11• Standard repairs - Problems and remedies .....	21
12• Warranty .....	22

# THANK YOU!

You are now the proud owner of an Etesia brush-cutter! This extremely reliable and tough machine has been specially designed to give many years of service.

- In order to prolong the life of your brush-cutter and keep it in excellent working order, read this manual carefully and always follow the safety recommendations and maintenance instructions.
- As part of our commitment to excellence, we are constantly seeking new ways of improving our products.
- For this reason, your model may differ slightly from the description in this manual.
- Up-to-date technical information can be obtained from your dealer.
- He will be happy to resolve any queries you may have.

• In accordance with article L.111-3 of the consumer code, ETESIA undertakes to supply your dealership with spare parts, original or compatible, indispensable for the use of your product over a period of 10 years, as from the date of the invoice issued by our company.

## INTRODUCTION

- Before you use the machine, read the instructions for use thoroughly, paying particular attention to the advice concerning your safety and that of others.
- Keep this manual in a safe place for later consultation.
- This professional brush-cutter is designed specially to cut grass and plant growth on flat terrain or sloping up to 20°, with medium maintenance, where a lawn mower would give less satisfactory results.
- Any use other than for cutting grass and small shoots is not in compliance with the instructions and is not recommended.

## 1 • YOUR SAFETY AND THAT OF OTHERS

### USER RESPONSIBILITY

#### BEFORE USING YOUR BRUSH-CUTTER

- Before using your brush-cutter, make sure that you are completely familiar with the controls and operating instructions so that you are able to stop the machine quickly.
- Always clear the lawn of toys, stones, pieces of wood or metal, wire, bones, plastic, branches and other debris liable to be thrown out by the brush-cutter. Low branches liable to cause injury to the user should also be removed.
- Before using the machine, ensure that the cutting blade is in good condition and tight and that the handlebar is locked.
- Loose clothing and short trousers should not be worn when using the brush-cutter.
- Always wear stout and closed shoes. Never use the brush-cutter barefoot or wearing sandals.
- Wear ear defenders.

#### YOUR SAFETY AND THAT OF OTHERS

- Always follow these instructions when using your brush-cutter.
- Children under the age of 16 years, and people not familiar with the brush-cutter must not be allowed to use the machine.
- Never let a person who has not read the instruction booklet take charge of the brush-cutter.
- **WARNING** : Prolonged exposure to noise can be dangerous to health. The symptoms are progressive: tinnitus, temporary hearing loss, then progressive deafness. Use personal protection against noise. Limit the intensity and duration of exposure. Avoid mowing close to other sources of sound. Allow for rest periods.
- **WARNING** : Excessive exposure to vibration can affect the circulation or the nervous system. The symptoms appear mainly in the fingers, the hands or the wrists. These symptoms may include loss of sensation, pain, muscle weakness, change in colour of the skin, disagreeable tingling... Consult a doctor in case of appearance of symptoms that may be triggered by vibrations.
- Never drive your brush-cutter too close to embankments or ditches, on soft ground, or where there is a risk of overturning.
- Never operate the machine when feeling tired or unwell.

- Never operate the machine after consuming alcohol or taking medicine.
- The user is responsible for ensuring the safety of others within the area where the brush-cutter is being used.
- Keep third parties out of the way whilst mowing to avoid injury to others caused by flying stones and other objects.
- The user is responsible for ensuring the safety of others within the area where the brush-cutter is being used. Do not start the machine if there are any around you.
- Never remove warning labels or safety instructions.
- The machine must be equipped with its safety flaps.
- Before changing the cutting height adjustment, stop the engine or the blade rotation.
- Never place hands or feet under the cutter housing.
- Keep your hands and your legs clear of rotating or moving parts. Always keep clear of the ejection opening.
- The hydraulic transmission of your brush-cutter uses pressurized oil. Never start the brush-cutter without the hydraulic transmission cowl: pressurized hydraulic fluid that could escape could have sufficient force to penetrate the skin and cause serious injuries in which case medical help would be needed right away.
- Protect the face and the eyes when mowing under trees.
- Avoid obstacles such as mole hills, concrete pedestals, tree stumps and edging, which cannot be cut by the blade and which could damage the cutting mechanism specially the blade.
- After striking a foreign object or if the machine starts to vibrate abnormally stop the motor, disconnect the spark plug cover and inspect the brush-cutter for any damage. Have any repairs made before restarting and using the brush-cutter.
- The blade must be changed after any shock.
- Operate the brush-cutter only in broad daylight or with good artificial lighting.
- Do not mow during thunderstorms.
- Whenever possible, do not mow wet grass.
- Respect the minimum safety distance given by the handlebars.
- When using the brush-cutter on slopes, it is necessary to be particularly careful and to exercise a great deal of caution when changing direction. Never mow up or down the slope, always mow across.
- It should not be used on slopes that are too steep (max. 20°).

# 1 • YOUR SAFETY AND THAT OF OTHERS

- Be very careful if you reverse the brush-cutter or pull it back towards yourself.
- Do not change the motor speed regulation settings or use the motor at too high a speed.

**WARNING :** never allow the engine to run in confined areas. Exhaust gases contain carbon monoxide, which is odourless and can kill.

- Never close the choke flap when the engine is running or when it is hot.
- Never leave the engine running unsupervised (even if the machine model allows).
- Stop the engine for any maintenance on the brush-cutter.
- The drive and blade clutch levers never have to be locked in working position.
- If the brush-cutter has to be lifted or transported, stop the engine and remove the spark plug cap.
- If you drive the brush-cutter out of the lawn, stop the engine or the blade.
- By loading and unloading the machine it is recommended to use ramps or to ask help for the loading operation.
- Be sure also to comply with any legal requirements relating to the use of machines with thermal engines.
- These precautions are essential for your safety.
- The recommendations given are not exhaustive however. Use your brush-cutter judiciously at all times.

## MAINTENANCE AND STORAGE

- Always maintain the machine and accessories in perfect working condition.
- Replace worn or damaged parts for greater safety.
- Cleaning or servicing the brush-cutter should not be started before having stopped the engine and disconnected the spark plug.
- Always use petrol that you have bought recently.
- Old petrol leave deposits in the carburettor, causes leaks and makes starting the engine difficult.
- Only buy the amount of fuel you need for on month's use and keep it in a clean jerrican set aside for this purpose.

**WARNING:** fuel is highly flammable.

- Never store, pour or use petrol near a naked flame or near devices such as stoves, water-heaters with pilot lights or any other device liable to produce sparks.
- Always fill in the fuel tank outside a building.
- Always fill the fuel tank in the open and do not smoke during this operation.
- Add fuel before starting the engine.
- Never remove the fuel cap whilst the engine is running or hot.
- Allow the engine to cool for few minutes before filling.
- Ensure that the fuel tank and fuel can caps are replaced correctly.
- Do not attempt to start the engine when any petrol has been spilt, when you can smell petrol or when other explosive conditions are present.
- Remove the brush-cutter from the spillage area and avoid causing any source of ignition until the petrol vapour's have dispersed.
- Do not carry or store the brush-cutter with petrol in the tank or with the feed tap open.
- Do not modify the regulator springs, rods or other parts to increase the engine speed.
- Operate the engine at the recommended speed.
- Do not check the spark by removing the spark plug.
- Use an approved checking system.

- Do not pull the starter when the spark plug is removed.
- If the engine is flooded, bring the gas lever to the MAXI position and pull until the engine starts.
- Do not knock the engine wheel with a hammer or hard object. Otherwise, the wheel may break during operation. Have all major servicing operations performed by an authorized ETESIA dealer who has the appropriate tools.
- Do not use the engine without the silencer.
- Check the silencer regularly and have it replaced if its is damaged or leaking.
- Do not touch the exhaust pipe, cylinder or fins when hot. Otherwise, you may get burnt.
- Do not use the brush-cutter in wooded areas, brush or on fallow or grassy ground if the exhaust pipe is not fitted with a spark arrester (the owner or user is responsible for ensuring that the spark arrester is in good condition).
- Do not start the engine when the air filter or air filter cover is removed.
- To prevent the engine from starting accidentally, remove the spark plug cap during servicing operations.
- Clean the cylinder fins and regulator mechanism of any dirt, grass residues and other materials which could alter the engine speed.
- Check the fuel piping and connections for cracks and leaks and have them changed if necessary.
- The spare blades must only be fitted on machines for which they are designed, in accordance with the instructions.
- The use of counterfeit parts or poor maintenance can alter the performance of your product, or present a danger to you and other people. Use only original parts and follow the maintenance schedule.

## RESPONSABILITY

- In the event of any use not in accordance with the relevant instruction booklet, ETESIA can accept no liability. Do not dump your grass clippings in unauthorized areas.
- You must not make any modifications to the brush-cutter without the prior approval of ETESIA.
- Any modification not authorized by ETESIA could render the machine dangerous and lead to serious injury during use. ETESIA shall accept no responsibility if these instructions are not followed.

## IDENTIFICATION OF THE BRUSH-CUTTER

- The serial number is on the identification label on your brush-cutter.
- Always give this number to your dealer for all servicing on your brush-cutter.
- You will only be ready to use this brush-cutter after you read the safety instructions.
- Read completely this manual for the using and the servicing of the brush-cutter.

## 2• KEY TO DIAGRAMS - SAFETY



This symbol appears in the instruction manual alongside those sections which deal with user safety.



This symbol appears in the instruction manual alongside important information on how to prolong the life of your brush-cutter.

### • ENGINE DIAGRAMS

- Your instructions contain important information on operational safety.
- Read them before using the motor.
- Exhaust fumes contain carbon monoxide, an odourless poison that can cause severe nausea, fainting or death. Avoid inhaling exhaust fumes.
- Do not run the motor in an enclosed area.

- Gasoline is extremely flammable and explosive and can cause fires and severe burns. Do not fill the fuel tank when the motor is running or hot.
- Gasoline is extremely flammable and its vapours may cause an explosion in the presence of an ignition source. Store gasoline only in approved containers and in unoccupied and well ventilated buildings, away from sparks or flames. Spilled fuel could ignite on contact with hot parts or sparks during ignition. Never use gasoline as a cleaning agent.
- The motor can become very hot during normal operation. Hot parts can cause severe burns.
- Stay away from hot parts of the motor. Do not touch the motor while it is operating or just after stopping. Never operate the motor with the heat shields or guards removed.
- Let the engine cool down before refueling.

a

b

c

d

e

f

g

h

i



### DESCRIPTION OF THE SAFETY LABELS

- Hearing protection must be worn.
- WARNING DANGER !
- Before using, please read and follow the safety and maintenance instructions included in the manual.
- Caution of the cutting blade. The blade continues to rotate after the engine stops. Finger cut risks.

- Stop the engine, disconnect the spark plug before proceeding any services on the mower.
- Risk of projected objects.
- Keep the third persons away from the machine.
- WARNING DANGER !
- Do not operate the brush-cutter without protective covers.

b

d

f

h



a



c

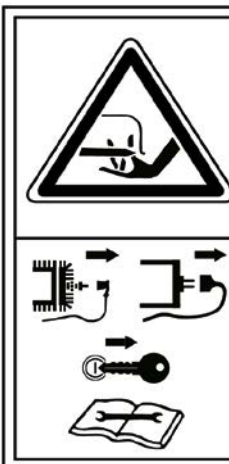

e



g



i

## 2• KEY TO DIAGRAMS - USE

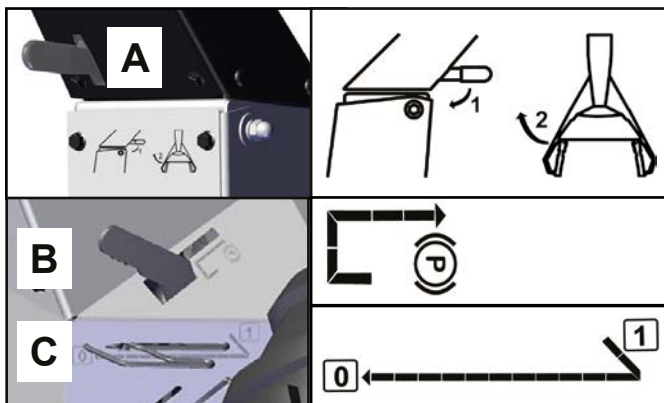
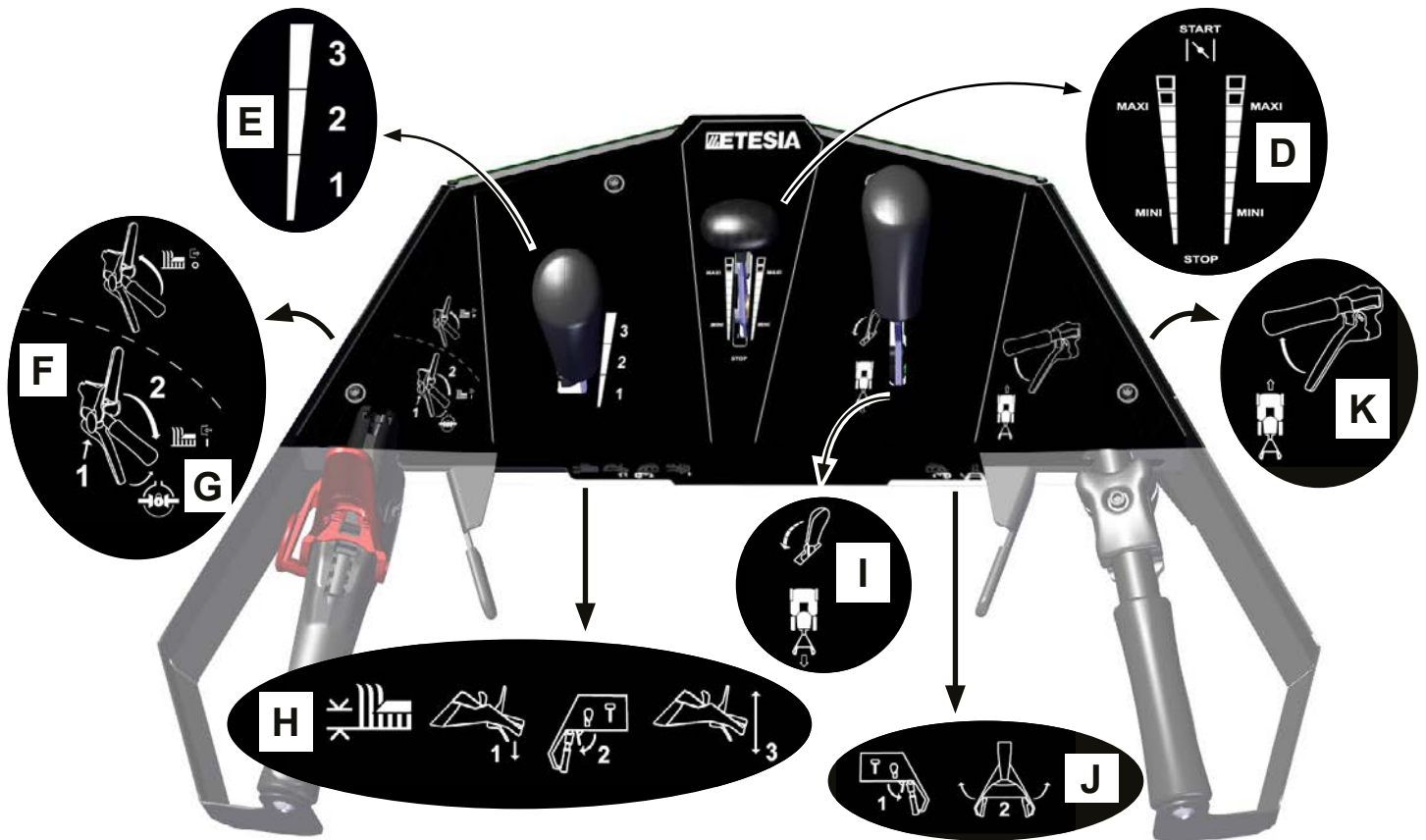

### A - FOLDING CONTROL OF HANDLEBAR

- 1 - Operate the offset control on the right of the handlebar. While holding this control active, press the button at the base of the handlebar.
- 2 - Rotate 180° to the left.

### B - PARKING BRAKE

- To engage the parking brake, pull the brake lever towards the back of the machine and release it from its lock.
- To release the parking brake, pull the brake lever back and engage it.

### C - BY-PASS ADVANCED TRANSMISSION

- Pull the bypass control to position (0) to move the brush-cutter off.
- Reposition the control (1) to use the feed.

### D - THROTTLE CONTROL LEVER

- START position to start a cold engine.
- Maximum rate
- Minimum rate
- STOP position to stop the engine.

### E - SPEED CONTROL LEVER

- Forward speed 3
- Forward speed 2
- Forward speed 1

### F - BLADE CLUTCH CONTROL

#### Start

- 1 - Push the red safety button to the right and hold it.
- 2 - Apply the blade clutch control lever to the handlebar, then release the safety button.

#### Stop

- To stop the blade release the blade clutch lever: the blade is on stop and braked.

### G - DIFFERENTIAL BLOCKING

- Operate the differential lock lever.
- To return to active differential configuration and improve handling, release the differential lock lever.

### H - CUTTING HEIGHT

- 1 - Push the handlebar downwards to reduce the control effort.
- 2 - Operate the cutting height adjustment control.
- 3 - Lower or mount the handlebar to the desired height. Release the cutting height adjustment control.

### I - REVERSE CONTROL

- To retreat, pull the control back.
- To stop, release the command.

### J - SIDE DEPTH OF HANDLEBAR

- Operate the offset control.
- Swivel the handlebar to the left or right and release the control.

### K - DRIVE CONTROL

- To move forward, push the control lever against the handlebar.
- To stop, release the control lever.

### 3• DESCRIPTION

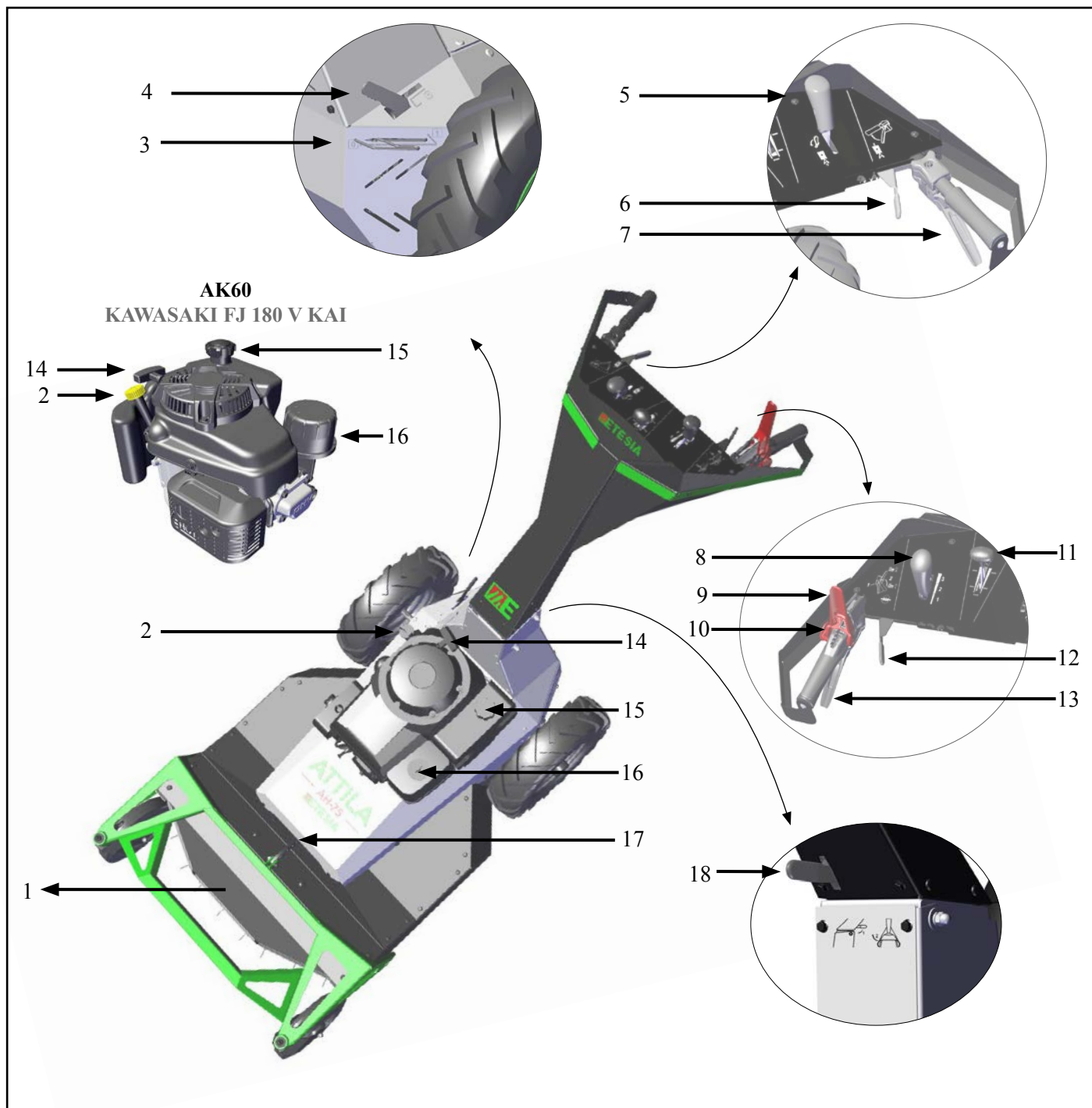

1. Safety flap
2. Gauge / Oil filler tube
3. By-pass
4. Parking brake
5. Reverse control
6. Side depth control of handlebar
7. Drive control lever
8. Speed selector lever
9. Blade clutch lever
10. Blade clutch safety button
11. Gas lever
12. Cutting height adjustment control

13. Differential lock control
14. Starter handle
15. Fuel tank cap
16. Air filter
17. Cutting height indicator
18. Folding control of handlebar

#### SPARE PARTS

Kit of 2 flails: MC85  
 Blade body: 50673 (AK60), 50533 (AH75)  
 Fuel preservation: 09800  
 Anti-puncture tyre liquid: 28461

# 4• PICTURES

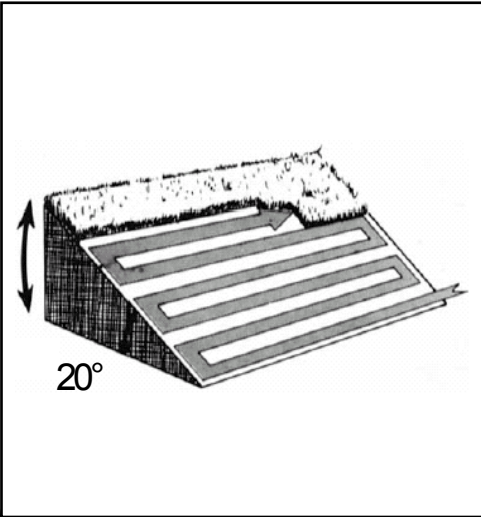

1

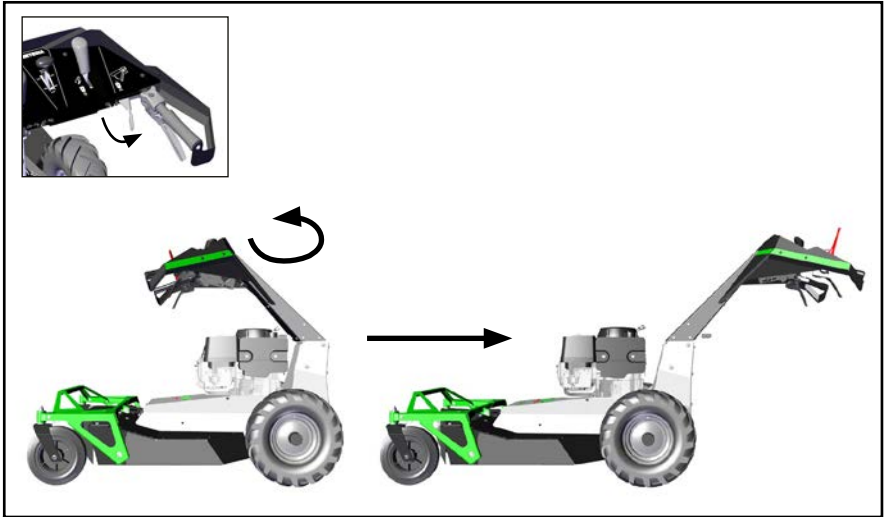

2

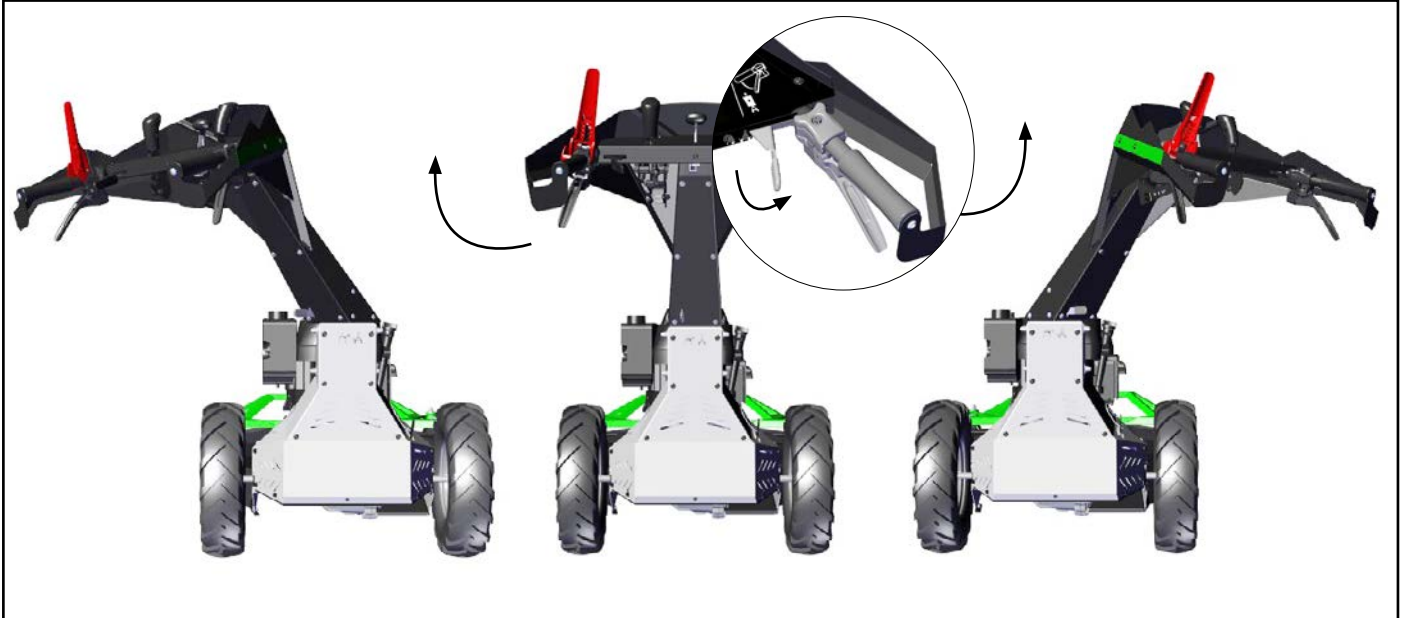

3

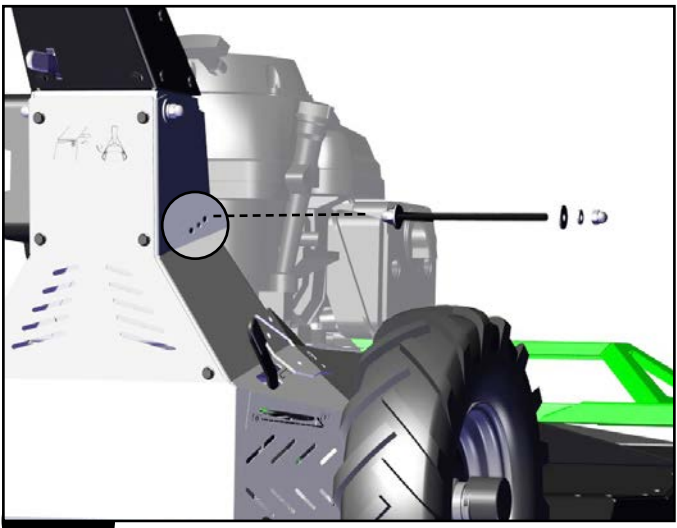

4

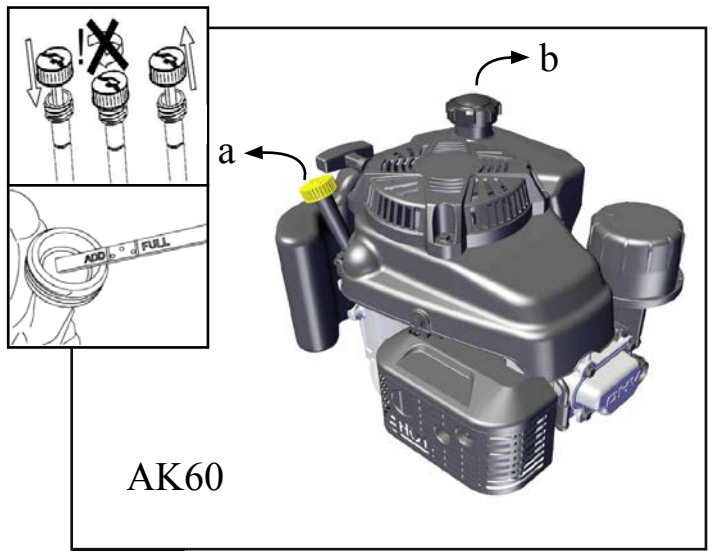

AK60

5



# 4• PICTURES

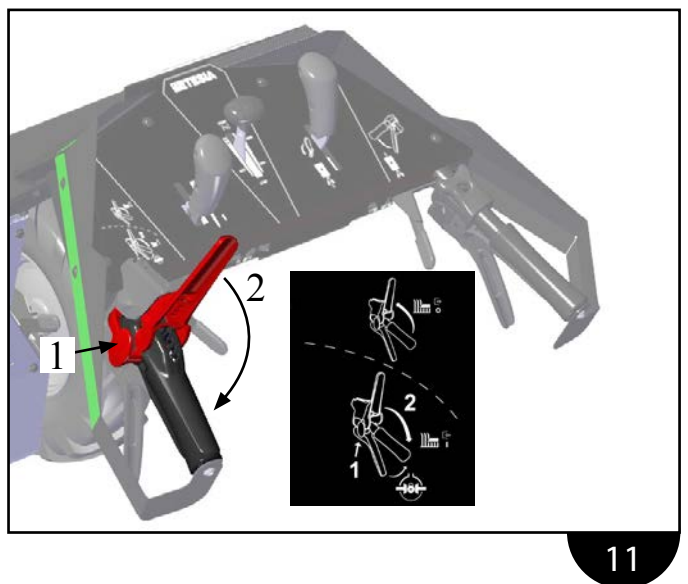
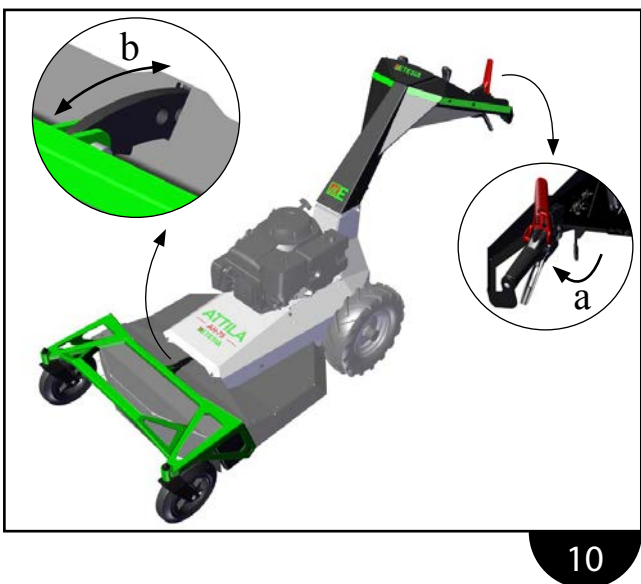
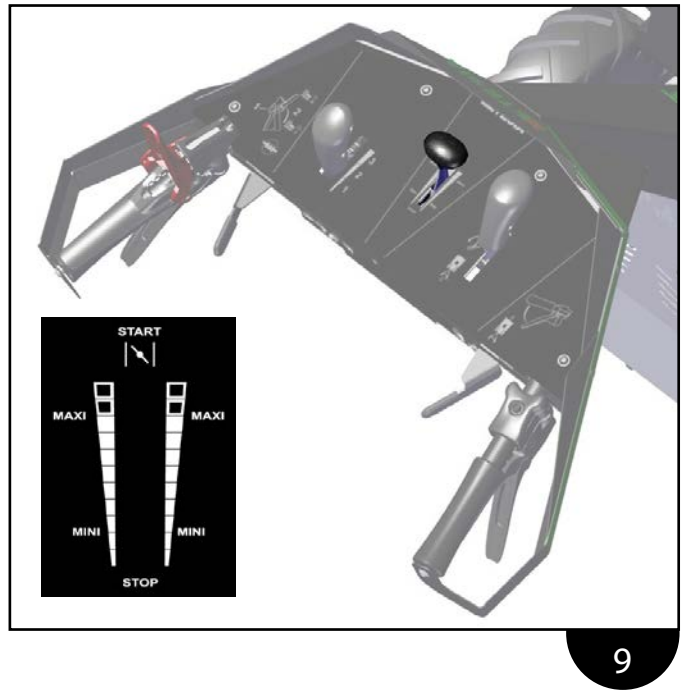
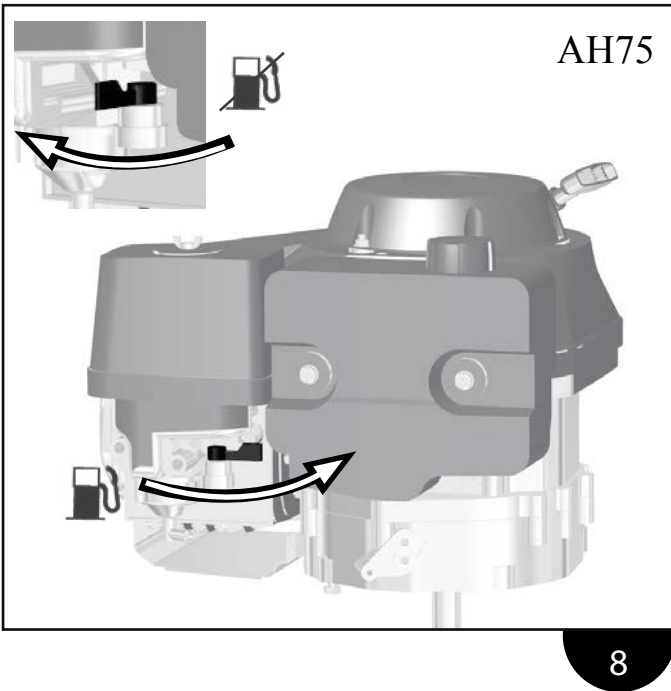
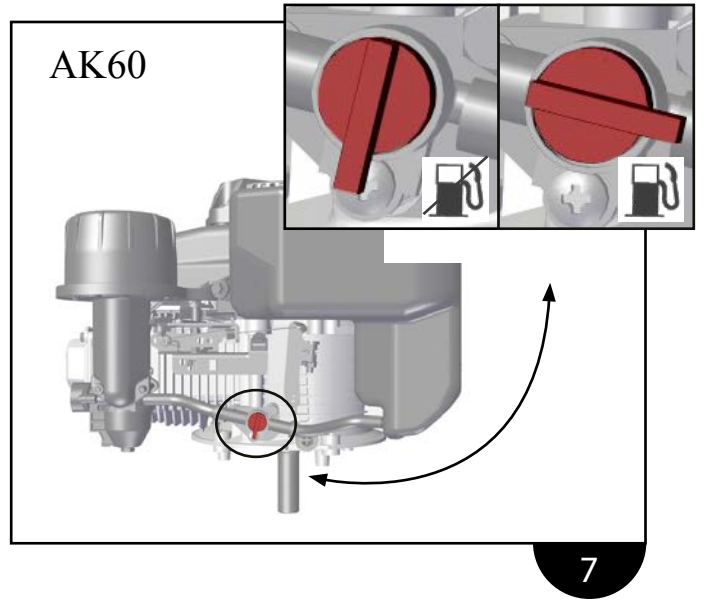
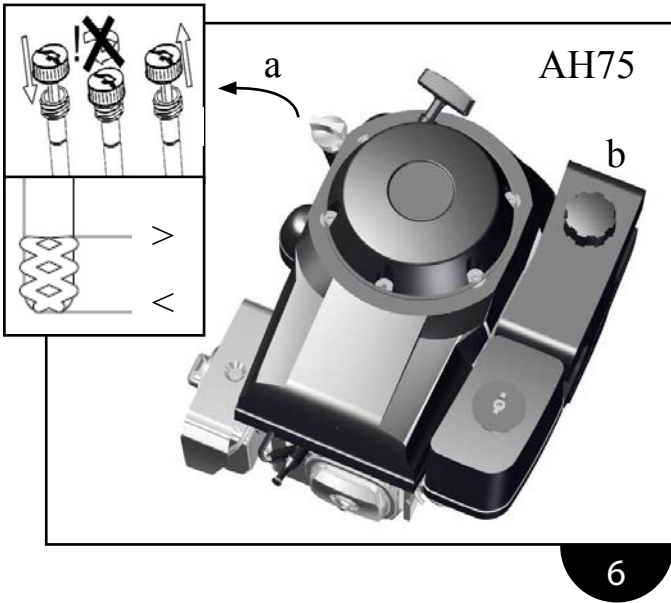

# 4• PICTURES

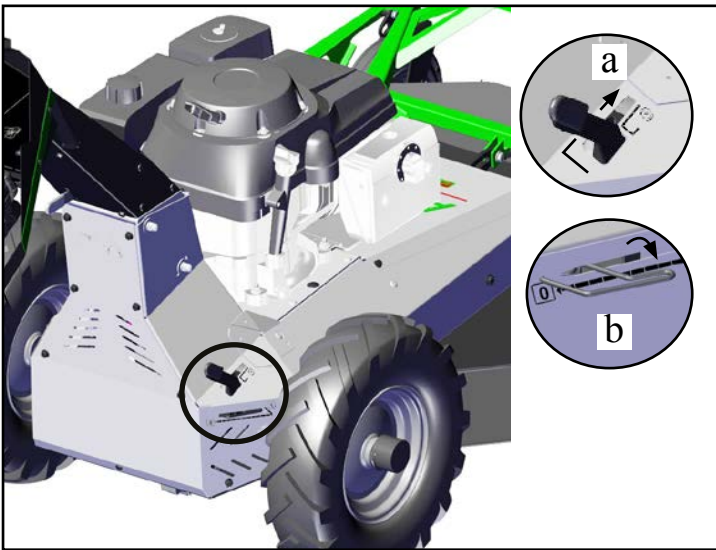

12

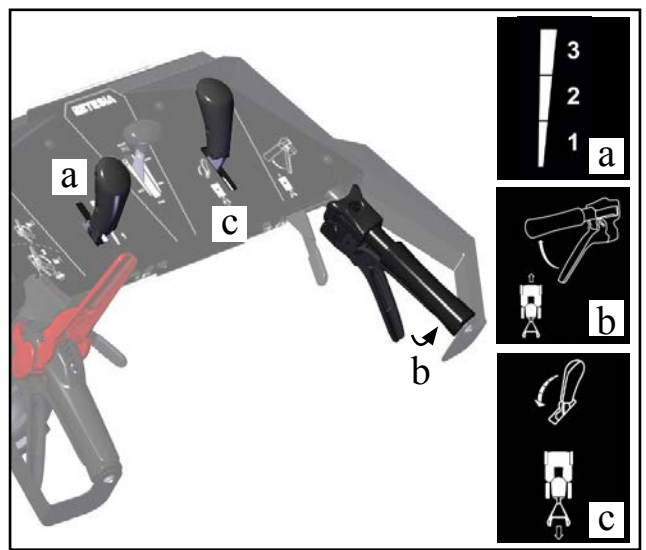

13

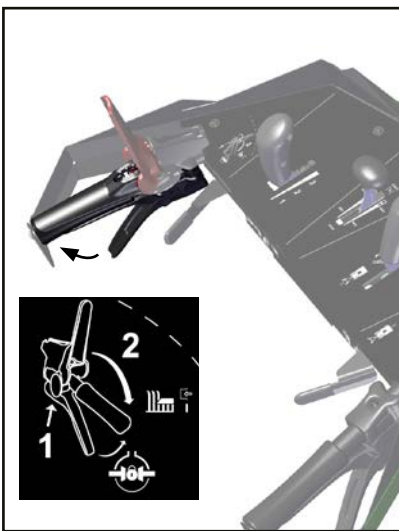

14

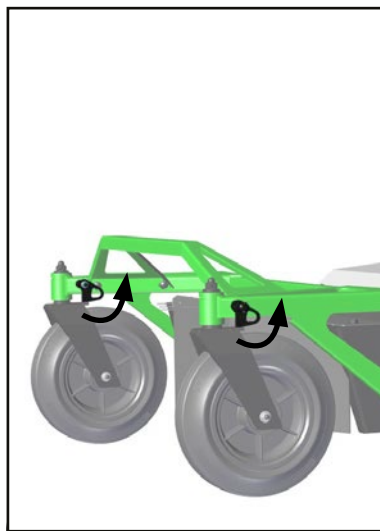

15

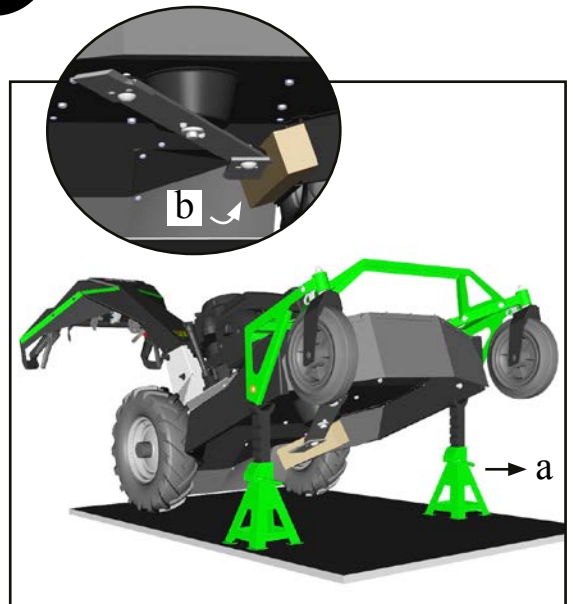

16

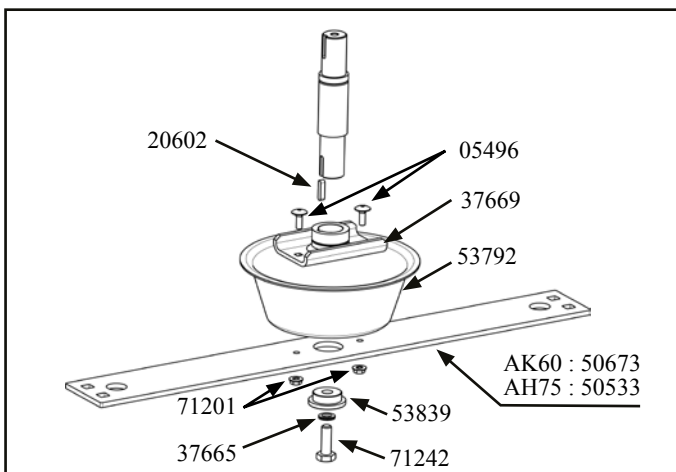

17

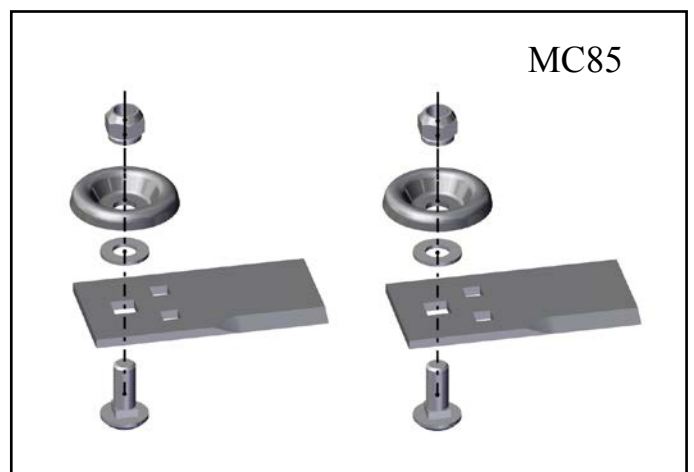

18

# 4• PICTURES

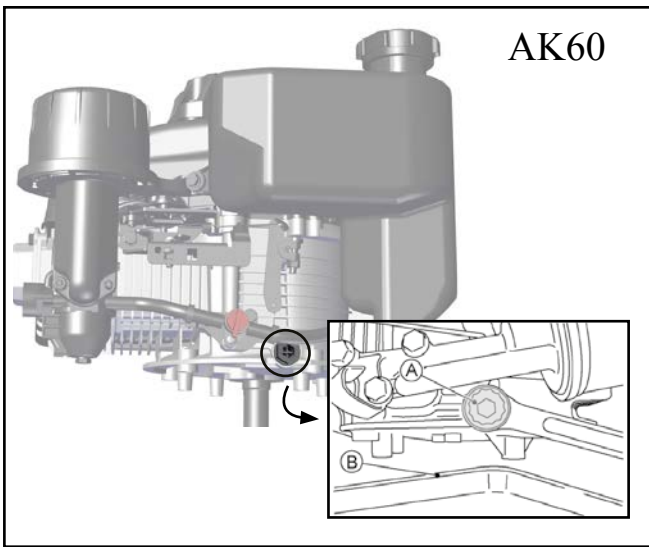

19

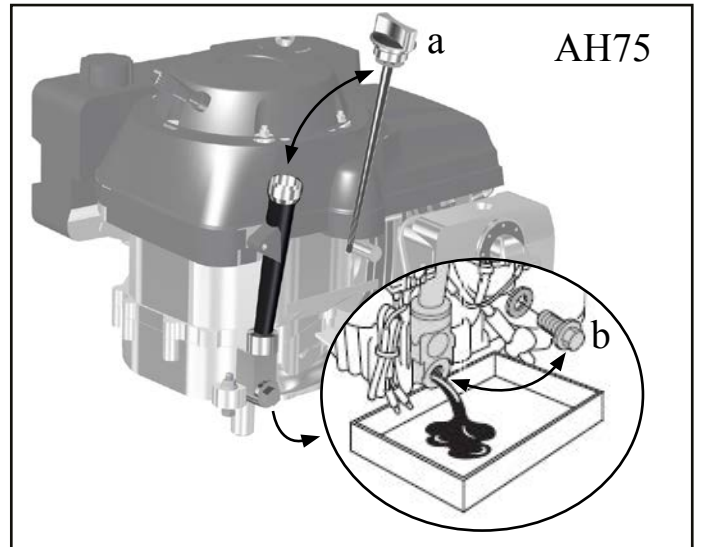

20

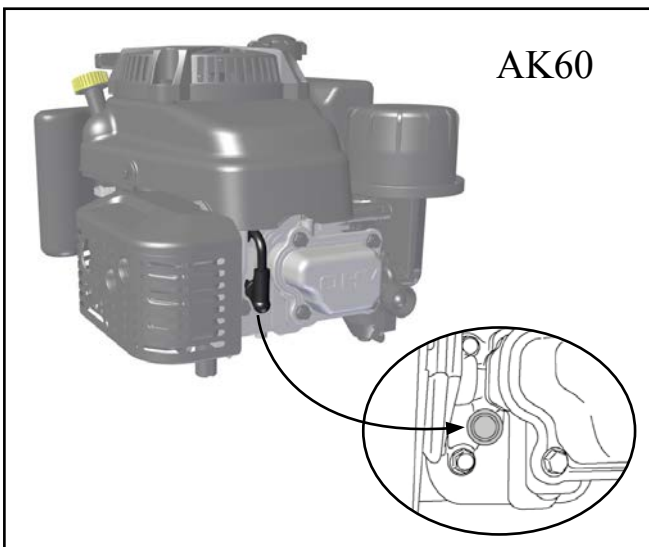

21

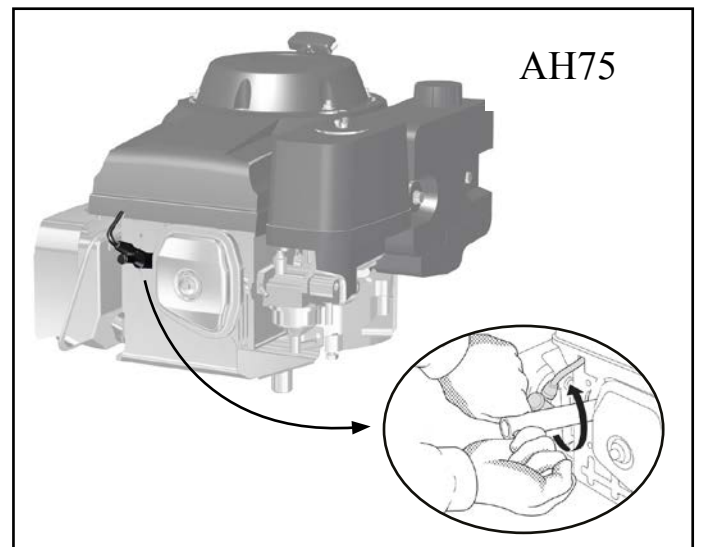

22

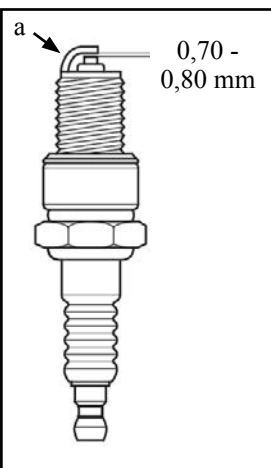

23

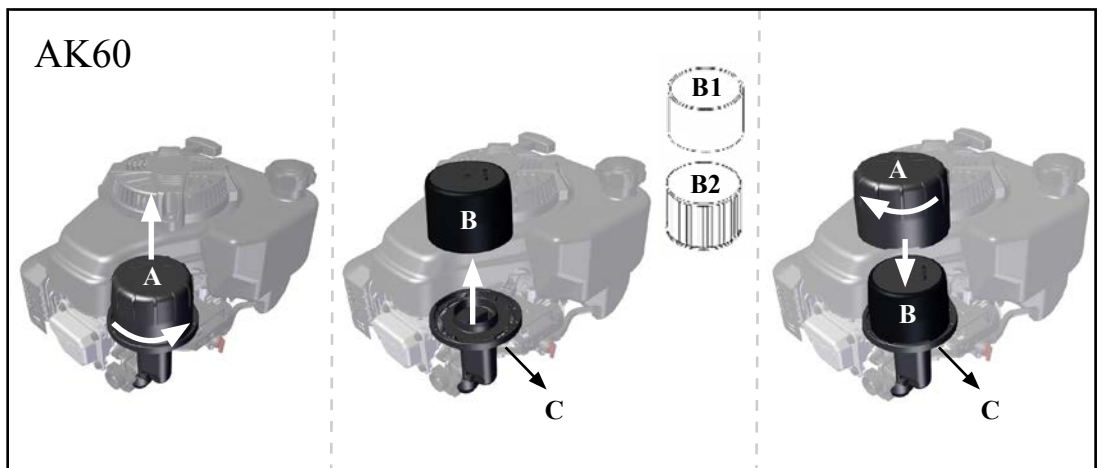

24

## 4• PICTURES

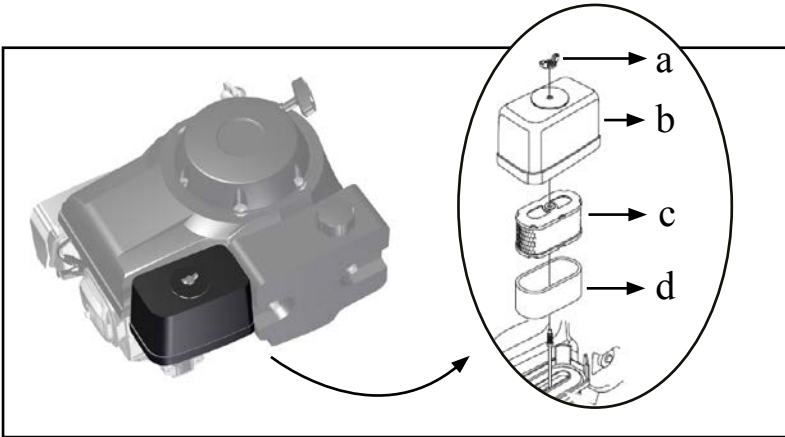

25

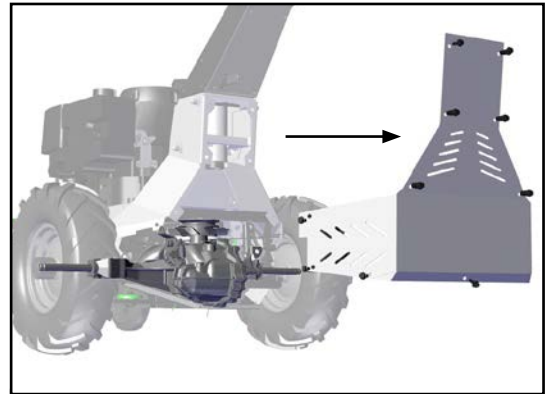

26

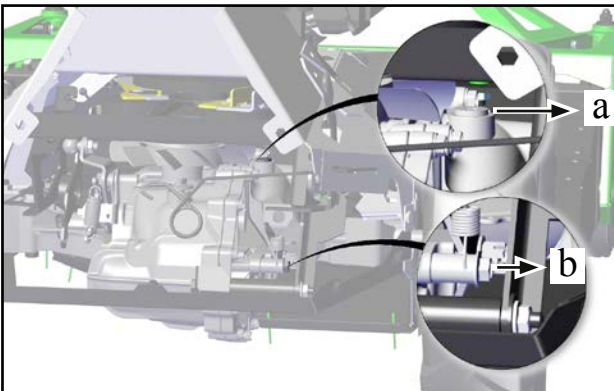

27

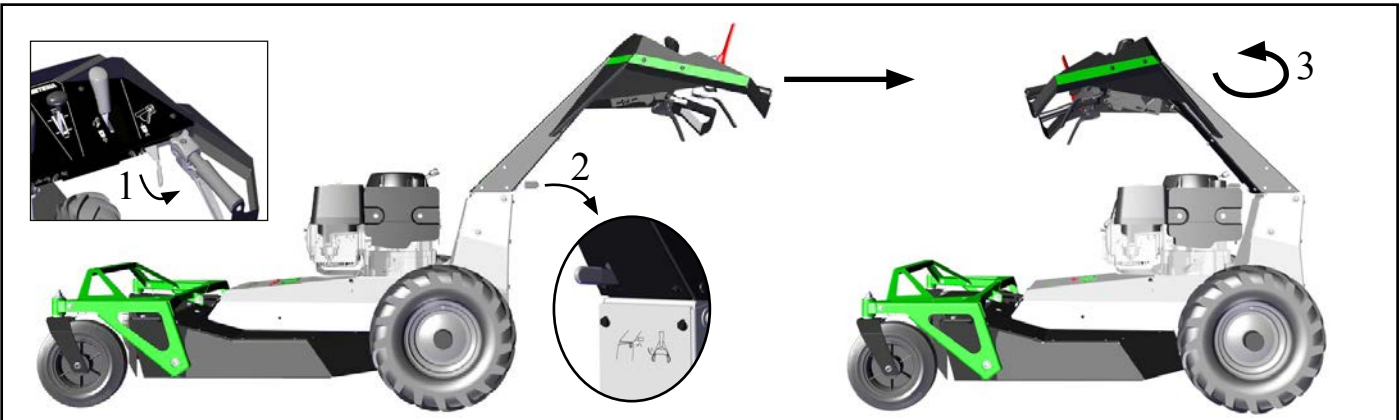
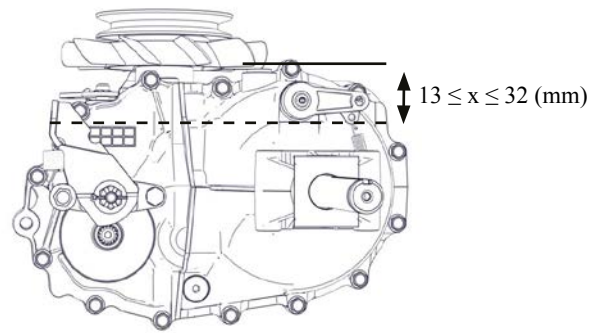

28

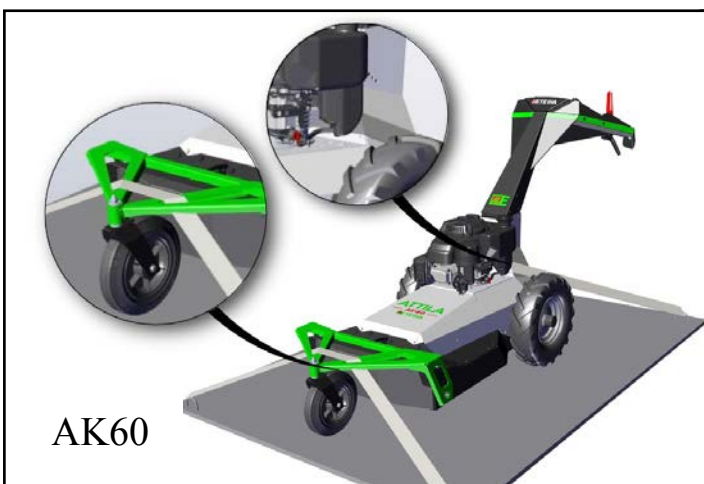

AK60

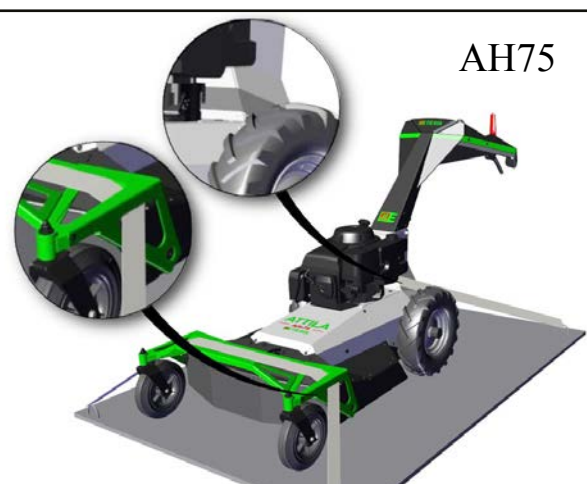

AH75

29

## 5• TECHNICAL SPECIFICATIONS

	AH75	AK60
Version	Self propelled with hydraulic transmission, differential lock and blade disengagement system	
Engine	Honda GXV 390 - 4 stroke - OHV	KAWASAKI FJ 180 V KAI - 4 stroke - OHV
Piston displacement	389 cm <sup>3</sup>	179 cm <sup>3</sup>
Bore / Running	88 x 64 mm	54 x 65 mm
Power at rated speed	7,5 kW	3,3 kW
Rated speed	3300 min -1	3300 min -1
Performance	3225 m <sup>2</sup> /h	2580 m <sup>2</sup> /h
Starter	Recoil	
Engine oil	SAE 30, 10W30 or the oil recommended by Etesia (ref. 38383)	
Oil tank capacity	1,1 l	0,65 l
Fuel	Unleaded fuel	
Tank capacity	2,1 l	4 l
Carburettor	Float-type with manual starter	
Cooling	Air cooled	
Air filter	Paper cartridge + foam prefilter	
Ignition	Magnetic transistor	
Spark plug	Résistive - culot Ø 14 mm x 19 mm - réf : 03861	
Electrode gap	0,7 - 0,8 mm	
Cutting width	75 cm	60 cm
Cutting height	Adjustment in 3 positions 50 - 75 and 100 mm	
Dimensions (LxHxh)		
Handlebar folded	1380 x 880 x 1140 mm	1370 x 765 x 1140 mm
Handlebar in working position	2130 x 880 x 1140 mm	2100 x 765 x 1140 mm
Wheel diameter / wheel width	Front : 250 mm / 65 mm Rear : 430 mm / 110 mm	
Weight	148 kg	122 kg
Drive speed	Forward 1 : 2,9 km/h Forward 2 : 3,6 km/h Forward 3 : 4,3 km/h Reverse : 2,5 km/h	
Noise level at control position *	L <sub>pA</sub> = 91 dB(A) (K <sub>pA</sub> = 2,5)	L <sub>pA</sub> = 86 dB(A) (K <sub>pA</sub> = 2,5)
Acoustic power level *	102 dB (A)	96 dB (A)
Vibration levels at the handle **	a <sub>hw</sub> = 3,9 m/s <sup>2</sup> (K = 1,95)	a <sub>hw</sub> = 5,2 m/s <sup>2</sup> (K = 2,6)
Values to specify the daily exposure time	A (8) = 3,9 m/s <sup>2</sup> The machine can be used for 12 hours and 50 minutes with interruptions every 3 hours and 10 minutes	A (8) = 5,9 m/s <sup>2</sup> The machine can be used for 5 hours and 45 minutes with interruptions every 1 hour and 25 minutes

\* Reference standards for measurements = NF EN 12733, EN ISO 3744

\*\* Reference standards for measurements = NF EN 12733

## 6• PREPARATION AND GETTING STARTED

### HANDLEBAR

#### POSITION OF USE (PICTURE 2)

- Operate the offset control on the right of the handlebar.
- Swivel the handlebar 180 ° to the rear.
- Release the offset command.

#### LATERAL RELEASE OF THE HANDLEBAR (PICTURE 3)

- Operate the offset control on the right of the handlebar.
- Swivel the handlebar to the left or right.
- Release the offset command.

#### HEIGHT ADJUSTMENT OF THE HANDLEBAR (PICTURE 4)

- Unscrew the nut using 2 x 13 mm wrenches and remove the two washers and the threaded rod-washer-nut assembly.
- Hold the handlebar at the top and position it at the desired height.
- Replace the threaded rod-washer-nut assembly, the two washers and tighten the nut.

### ENGINE PREPARATION



Your brush-cutter is delivered with oil in the crankcase. However, check the level before use and top up if necessary.



Never run an engine without oil even for short periods of time.

Use an excellent quality detergent oil in class “SJ” or higher and with a viscosity of SAE 30, 10W30 or the oil recommended by Etesia (ref. 38383).

- Place the brush-cutter on a horizontal and unencumbered area.
- Unscrew the cap and take out the dipstick (a pictures 5 and 6).
- Slowly pour oil. The oil capacity is 0,65 l for the AK60 model and 1,1 l for the AH75 model.
- Insert the dipstick in the filler tube and bring the cap to bear without screwing it down.
- Take off the gauge and check the oil level. The mark left on the gauge must reach the FULL mark for the AK60 model and the upper limit for the AH75 model (a pictures 5 and 6). Top up if necessary.
- In case of excess, recover the overflow with a syringe.
- When the level is correct, firmly screw in the cap of the filling tube.
- Then fill the fuel tank with unleaded fuel (b pictures 5 and 6). Use recently purchased fuel stored in a jerrycan specially reserved for this purpose. Only buy the quantity of fuel you can use within 1 month. The tank capacity is 4 l for the AK60 model and 2,1 l for the AH75 model. Avoid spilling petrol and overfilling the tank to prevent overflowing: leave approximately 1,5 cm space under the filler collar to allow the fuel to expand.



**CAUTION!** Petrol is highly inflammable. Do not smoke while filling with petrol. The tank should always be filled with the engine switched off.

- Never remove the fuel tank cap while the engine is running.
- If petrol has been spread, do not try to start the motor. Take the machine away from the spoiled area and make sure there is no form of ignition as long as the petrol vapour is not dispersed.
- Put the fuel tank cap and the fuel can properly.
- Avoid fuel overflow while filling the fuel tank. In spite of these precautions should it happen, please :

a) Clean, as good as you can, all the contaminated parts.

- b) Don't start the machine as long as you're not sure that all the spread fuel has been eliminated.



Never add oil to the petrol! Adding a fuel saver marketed under number 09800 will keep your fuel good for up to 6 months.

### STARTING AND STOPPING THE ENGINE



Before use, always make a visual check to ensure that the blade, attaching screws and coupling are not worn or damaged. Also check that the handlebar is locked.

#### STARTING THE ENGINE

- Open the fuel tap (pictures 7 and 8).
- Place the throttle lever on position [I/N] (picture 9) (the choke valve will shut automatically).
- Make sure that the blade brake clutch and drive control levers are not operated.
- Stand on the right of the handlebar, behind the brush-cutter.
- Slowly pull the starter unit handle until you feel the compression.
- Return to first position before pulling vigorously to start the engine. Hold on and follow the starter handle back to first position.
- When the engine has started, put the throttle lever on [MAX] position (2 picture 9).

#### STARTING AN ENGINE WHICH HAS BEEN RUNNING ALREADY

- Place the throttle in position [MAX] (picture 9) and start the motor.



Never leave the engine running in closed areas where carbon monoxide, a dangerous substance, could build up.



The oil gauge has to be fully screwed when the engine is running.



Do not change the original settings of the engine and do not let the engine race. In the event of maladjustment, contact your ETESIA dealership.

#### STOPPING THE ENGINE

- Pull the throttle lever gently to [STOP] position (picture 9).
- Close the petrol tap (pictures 7 and 8).

# 7• OPERATING INSTRUCTIONS

## CUTTING HEIGHT ADJUSTMENT



Proceed only after engine has been switched off.

- Push the handlebar downwards to reduce the control effort.
- Operate the cutting height adjustment control (a picture 10).
- Lower or mount the handlebar to the desired height (3 positions) (b picture 10).
- Release the cutting height adjustment control.

## STARTING AND STOPPING THE BLADE

### BLADE BRAKE CLUTCH

- This safety device controls the blade rotation of your self-propelled brush-cutter. The machine drive can also be used apart from blade rotation, specially when taking the machine outside the cutting area.

### USE



Before you engage the blade, make sure that the engine is warm enough and that it's running at the maximum run (throttle control lever on [MAX] position).

- Stand behind the handlebar in working position and keep your feet away from the cutting blade.
- Push the red safety button to the right and hold it (1 picture 11).
- Apply the blade clutch control lever to the handlebar (2 picture 11), then release the safety button. The blade will remain engaged after releasing the safety button as long as the clutch lever is held against the handlebar.



Don't engage the blade when it's in contact with long uncut grass as it could cause difficulties to start.

### BLADE STOP

- Release the blade clutch lever to stop blade rotation. The blade will be automatically braked and stopped within 7 seconds.

### PARKING BRAKE (A PICTURE 12)

This security feature locks the wheels so as to immobilise your brush-cutter.

- To engage the parking brake, pull the brake lever towards the back of the machine and release it from its lock.
- To release the parking brake, pull the brake lever back and engage it.

### DRIVE SPEED ADJUSTMENT

The hydraulic transmission enables the drive to be adapted to all cutting conditions through progressive speed variation controlled by the control lever.

Opt for a slow speed (position 1) when the conditions of use are difficult (wet grass, high or too dense, uneven ground).

Select a superior position (position 2 or 3) for a high speed if the conditions of use allow it: dry grass, neither too high nor too dense, flat ground or displacement of the brush-cutter with the blade stopped.

It is the observation of your terrain that will guide you in choosing the optimal speed of advancement.

### SPEED ADJUSTMENT

- Move the selector lever located on the left of the dashboard (a picture 13) in the notched position corresponding to the selected speed range (1, 2 or 3).

### DRIVE CONTROL

#### To move

- Act on the control lever (b picture 13). The speed is at maximum when the control lever is closed to the handlebar.
- To stop position, release the lever.

#### Go reverse

- To go into reverse, release the control lever. Pull the reverse lever (c picture 13) backwards. The speed of recoil is maximum when the speed selector is maintained in rear stop, it will be even more reduced that the reverse command will be accompanied to the initial position.
- To stop the machine, release the reverse control lever.



Be particularly careful when you use the reverse gear: disengage the blade, and do not let yourself be surprised by the machine's movement.

#### Disengagement of transmission

- Pull the by-pass control to [0] position (b picture 12).
- Do not forget to switch the control to position [1], to be able to use the transmission drive again.

### DIFFERENTIAL LOCK CONTROL

The differential can be locked to prevent the driving wheels from spinning and gain driving force on sloping ground or wet grass.

- Actuate the differential lock control lever (picture 14).
- Release the differential lock control lever to return to the active differential configuration and gain in handling capability.



Pay special attention when changing direction when using the differential lock.

### BLOCKING THE IDLING WHEELS (AH75)

In order to guarantee a good trajectory in reverse, the rotation of the idling wheels must be locked with the latch (picture 15).

### CUTTING - PRECAUTIONS FOR USE ON SLOPES

- Place the throttle control lever on [MAX] position.
- Engage the blade (double safety control).
- Engage the drive control lever.



Never touch the blade when it is rotating.

## 7• OPERATING INSTRUCTIONS



Take special care when changing direction on slopes. Never mow up or down the slope, always mow across (picture 1). Always keep a safe distance away from the brush-cutter cutting deck.



Stop the engine and disconnect the spark plug before removing any jams, or clear the cutting deck volute.



The various safety flaps are there to protect you against projectiles. Do not use the machine if these protectors are damaged or missing. Do not under any circumstances remove them.

- If you can not stop the engine with the main control, turn off the petrol cock (this will stop the engine within 3 minutes).

## 8• MAINTENANCE

- Before any maintenance and in particular if tilting the machine is necessary, close the fuel cock, run the engine until all the fuel still contained in the lines and the carburettor is exhausted and then disconnect the spark plug cap.

The best maintenance is above all the regular cleaning of your brush-cutter after each use (frame, wheels, transmission system...).

### CHECKING THE SAFETY DEVICES

- Regularly check that the safety flaps are in place and in good condition. Have it replaced if it shows any signs of wear or damage.
- Ensure you about the good functioning of the safety control, release the blade clutch lever to check the stop of the blade in less than 7 seconds.



If you notice something not working properly, contact your ETESIA dealer as soon as possible.

### CLEANING OF THE CUTTING UNIT (A PICTURE 16)

- In order to access the brush-cutter deck more easily, it is advisable to put the machine on a lifting table. It is also possible to tilt the front of the machine so that it is inclined by 20 ° by placing two jack on either side of the deck.
- Clean the brush-cutter particularly the inside of the cutting deck. Wear protective gloves and remove debris and remaining grass using a scraper and a brush.
- Never use a high pressure washer on the transmission parts or engine. Never use a hot water washer.

### MAINTENANCE OF THE CUTTING UNIT

All shocks against obstacles, or abnormal wear, may cause unbalance and deterioration of the bearings or indeed of the engine as a whole. In such cases the warranty becomes invalid. Use a new blade rather than risk damage to the motor due to excessive unbalance of a poor blade.

Whenever you need to work on the cutting system, first stop the engine and remove the key from the ignition. Wear working gloves to protect your hands.

Shear bolts provide a connection between the body of the blade and the blade coupling. In the event of violent impact, the instant shearing of these screws protects the entire transmission system.

Every time before you use the ride-on brush-cutter, check the condition of the blade (for any damage and wear).

If a blade has become blunt or is twisted, this will affect the standard of cutting.

A damaged blade could be particularly dangerous if a piece comes away and is ejected by the cutting system.

Replace immediately any worn or damaged blades.

The flails are reversible: after the cutting edge becomes worn, they can be turned around.

Also check that the blade coupling is in perfect condition and that the blade ends turn in the same plane.

If any damage is observed on a blade a more thorough examination of the other components will be necessary, for instance the cutting housing, blade coupling, shear bolts, blade bearing and belt.

If you do not know how to do it or you do not have the right tools, contact your ETESIA dealer.

### REPLACING THE SHEAR BOLTS

- You can purchase a set of 8 shear screws and nuts ref. 37762.
- Tighten the shear screws to a torque load of 10 Nm.

If you do not know how to do it or you do not have the right tools, contact your ETESIA dealer.

### REPLACEMENT OF BLADE BODY (PICTURES 16 AND 17)

- In order to access the brush-cutter deck more easily, it is advisable to put the machine on a lifting table. It is also possible to tilt the front of the machine so that it is inclined by 20 ° by placing two jack on either side of the deck (a picture 16).
- Lock the blade by placing a wooden wedge between it and the cutting housing (b picture 16) then detach the central screw with a 17 mm wrench.
- Before reassembling the blade coupling, grease the shaft and check the condition of the lock washer (ref. 37665), on coupling (ref. 37669), and key (ref. 20602).
- Tighten the blade screw to 50 Nm.

### REPLACING THE FLAILS

- Use spare part MC85 and assemble according to the exploded view of picture 18.

### REGULAR ENGINE MAINTENANCE OILING (PICTURES 5 AND 6)

- Check the engine oil level regularly : every day before starting the machine.
- Place the brush-cutter on a horizontal and unencumbered area.
- Clean carefully around the filler neck and take out the dipstick.
- Wipe the dipstick on a clean cloth, put it back into the filler neck without screwing the plug back in.
- Remove the dipstick once more to check the oil level : the mark left on the gauge must reach the FULL mark for the AK60 model and the upper limit for the AH75 model.
- Top up if necessary.



## 8• MAINTENANCE

- Do not fill the oil sump past the [FULL] (AK60) or the upper (AH75) mark on the dipstick.
- Screw the plug of the filler neck up tightly before starting the engine.

### OIL CHANGE

- Before any maintenance operation and to avoid any risk of the brush-cutter starting accidentally, disconnect the spark plug.
- The first emptying has to be done after the first 15 working hours. These hours have to be considered like a burn in period during which you have to run the engine carefully.
- Changing the oil has to be done every 50 hours or once a year for the model AK60 or every 100 hours (6 months) for the model AH75.



Draining the engine outside.



Drain the oil out when the engine is still warm : the oil will run out more easily than it would if it were cold.

### OIL CHANGE METHOD



Be careful with used hot oil. Remove the used oil and dispose of at authorised disposal centre.

#### AK60 (PICTURE 19)

- Remove the drain plug (A) on the side of the engine.
- Drain the oil into a suitable container (B).
- Replace the drain plug.

#### AH75 (PICTURE 20)

- Place a container under the engine to collect used oil. Remove the dipstick (a), the oil drain plug and the washer (b).
- Drain the oil completely.
- Replace the drain plug with a new washer. Tighten thoroughly.

#### AK60 - AH75

- Clean carefully around the filler neck and the dipstick.
- Pour the new oil carefully into the filler hole.
- Check the oil level.
- Top up if necessary.

### COOLING SYSTEM, CARBURETTOR

- Regularly remove grass cuttings around the starter unit.
- Clear the cooling fins and around the engine of any accumulations of grass. This way you will ensure that your engine is constantly and efficiently kept cool.
- The carburettor linkage must be kept perfectly clean.

### SPARK PLUG

To ensure proper engine operation, the spark plug should not show any deposit, and it must have a proper electrode gap. A dirty spark plug can lead to difficulty with starting and a constant loss of engine power.

Do not hesitate to change a worn spark plug when necessary.



Use only ETESIA original spark plugs (03861).

#### AK60 (PICTURE 21) / AH75 (PICTURE 22)

- Remove the spark plug with a 13/16 inch spark plug wrench.
- Check the spark plug. Replace it if it is damaged or dirty, if its sealing washer is in poor condition or if its electrode is worn out.
- Clean the electrodes every 50 hours or at least once a year for the model AK60 or every 100 hours or 6 months for the model AH75.
- Measure the electrode gap with a feeler gauge. If necessary, correct it by bending the side electrode (a picture 23). The distance must be 0.7 - 0.8 mm.
- Screw the spark plug by hand
- After putting the spark plug in place, tighten it with a spark plug wrench 13/16 to compress the washer (23 Nm).
- When installing a new spark plug, tighten 1/2 turns after it touches the washer to compress it. To install a used spark plug, tighten 1/8 - 1/4 turns after it touches the washer to compress it.
- Replace the spark plug every 100 hours of operation for the model AK60 or every 300 hours for the model AH75.

### AIR FILTER

If the air filter is dirty, the flow to the carburettor will be restricted. To prevent any carburettor malfunction, regularly maintain the air filter.

Running the engine with loose or damaged air filter components may cause premature wear or engine failure.

- It is inevitable that impurities will get into the air filter. That is why it is essential that you regularly remove the cartridge of the air filter for cleaning (every 25 hours for the AK60 model or every 50 hours (3 months) for the AH75 model or more often in dusty conditions).

#### AK60 (PICTURE 24)

- Unscrew the cover (A) of the air filter and remove it.
- Carefully remove all the paper cartridge with the prefilter (B).
- Clean the inside of the lid (A) and the base (C) of the air filter.
- Remove the foam prefilter (B1) from the paper cartridge (B2).
- Clean the paper cartridge (B2) by gently tapping it on a flat surface. Do not use solvent and do not use compressed air, as they could damage the cartridge.
- Do not oil the cartridge. Replace it if worn or dirty, every 300 hours or at least once a year.
- Wash the foam pre-filter (B1) in soapy water and dry thoroughly. Oil the pre-filter element and squeeze it in the hand to distribute the oil well and remove any excess. Reinstall it on the paper cartridge.
- Reinstall the new or cleaned cartridge (B) on its base (C).
- Replace the cover (A) of the air filter and screw it in.

#### AH75 (PICTURE 25)

- Detach the wing nuts (a) and remove cover (b).
- Clean the cover carefully.
- Removed carefully the paper cartridge (c) and the pre-filter element (d). Replace them as soon as they become damaged or too dirty.

## 8 • MAINTENANCE

- Wash the pre-filter in soapy water and dry thoroughly.
- Oil the prefilter element and press it in your hands to spread out the oil evenly and remove any excess.
- Clean the paper cartridge by tapping it gently on a flat surface in order to drop the excess dirt or carefully send compressed air from the inside to the outside of the filter. Never attempt to remove the dirt with a brush; brushing will force dirt into the fibres. Replace the element if excessively dirty or every 300 hours.
- Assemble the filter elements (d and c), reinstall cover (b) and screw on the nuts (a).

### HYDRAULIC TRANSMISSION

- To access the hydrostatic bridge, remove the rear cover (picture 26).
- Clean the hydrostatic gearbox cooling fins regularly and also check that the fan is in good condition.



Check the hydraulic oil level when cold.

Before unscrewing the hydraulic oil cylinder (a picture 27), clean it carefully and make sure that no impurities get into it.

Make sure that the oil level of the transmission is still correct. Top up if necessary (picture 27). We recommend 10W40 oil cans ref. 38383 (2 liters).

An oil change (b picture 27) must be carried out by your ETESIA dealer after 50 hours of operation, then every 200 hours.

### CHANGING TYRES

- Where it is necessary to remove a wheel, this should be done on firm, even ground.
- Do not attempt to carry out work on or under the mower if it has been raised on temporary supports or without taking proper safety precautions.
- If you do not possess appropriate tools or the knowledge needed to carry out the work, contact your dealer.

#### • Remove the wheels in the following manner:

- Stop the engine.
- Apply the parking brake.
- Secure the vehicle using chocks.
- Remove the wheel hub.
- Unscrew the 3 screws with a flat wrench of 10. Remove sideways the two securing rings.
- Place a jack under the rear part of the chassis on the side where the wheel needs to be replaced and lift until this wheel does not touch the ground anymore.
- Secure the machine by lying it on stable props. You can now remove the wheel from the shaft.

- For remounting, follow the same instructions in the opposite way. Do grease the wheel shaft.



**WARNING !** Do not lose the O shape key which fits in the wheel shaft.

- Check the screw tightness.
- Check the tyre pressure : 1 bar

### DISPOSAL OF USED TYRES

It is forbidden to leave standing, to lay down or to burn tyres in nature. Our dealer network has been informed about its obligation to take back, free of charge, all used tyres from ETESIA brush-cutters.

### STORAGE (PICTURE 28)

To reduce the space taken up by the brush-cutter during transport or for storage purposes, the handlebar can be rapidly folded towards the front by carrying out the following operations in this order :

- Operate the offset control (1) on the right of the handlebar.
- While keeping this control active, press the button (2) at the base of the handlebar for 180 ° rotation to the left (3).

### TRANSPORT (PICTURE 29)



If the machine has to be raised or transported, turn off the motor. Allow it to cool for at least 15 minutes before loading the brush-cutter into a vehicle.



It is advisable to use a loading ramp to load and unload the brush-cutter.

For any delivery on a trailer or in a van:

- Position the machine in the vehicle.
- Stop the engine.
- Engage parking brake.
- Close the petrol tap.
- Block the idle wheels (picture 15).
- Transporting your mower using straps (picture 29).

The brush-cutter must be kept horizontal to avoid oil or petrol overflow.

## 9• LONG STOP - WINTER STORAGE

### PREPARATION

- Start by cleaning carefully the brush-cutter particularly under the cutting deck.
- To avoid sediment, completely empty the fuel from the tank and, open the fuel tap and empty the fuel in the carburettor tank by unscrewing the emptying screw or by leaving the engine running until it becomes empty.



The tank emptying has to be done outdoors.  
Don't smoke.

- Disconnect the spark top.
- Engine hot, empty the oil frame. Fill with new oil until you reach the FULL mark for the AK60 model and the upper limit of the gauge for the AH75 model.
- Proceed to cleaning the air filter.
- Remove the spark and oil the cylinder with a spoonful of oil. Pull the starter several times to distribute the oil and protect the cylinder and valves from corrosion.
- Put the spark plug back.
- To prevent rust from forming, close the engine valves by pulling gently on the starter handle until you feel some compression.

- Before you put the machine back into place, cool the machine then drive it into a dry place on a shelf or a sheet of metal.



To reduce the risk of fire, store the machine in place free of grass, leaves and grease and far from any ignition spark.

- Of course you may leave this seasonal maintenance work to your ETESIA dealer if you wish. He will check that your brush-cutter is in good condition...so that it starts first go the following spring.

### TO PUT IT BACK TO SERVICE

- Proceed as follows :
  - Unscrew the spark and clean it with fuel. Allow to dry without replacing it.
  - Pull energetically several times on the starter cord to eliminate oil excess from the cylinder.
  - Refit the spark plug.
  - Check the oil level and tank with unleaded fuel.
  - Open the petrol tap before starting the engine.
- This seasonal maintenance can of course be done by your ETESIA dealer.

## 10• REGULAR MAINTENANCE SUMMARY

Remove the he spark plug cap before carrying out any work under the cutting deck.

### AK60

Element	Before each cutting	After the 15 first hours	Every 50 hours	Every 100 hours	Every 300 hours	Periodically	Observation
Engine oil	Check the level and adjust	Change the oil	Change the oil				Necessary to be able to claim for warranty
Air filter	Check condition				Replace the cartridge	Clean every 25 hours	
Spark			Clean - adjust the electrodes	Replace		Replace if used too much	

### AH75

Element	Before each cutting	After the 15 first hours	Every 50 hours	Every 100 hours	Every 300 hours	Periodically	Observation
Engine oil	Check the level and adjust	Change the oil		Change the oil			Necessary to be able to claim for warranty
Air filter	Check condition		Clean		Replace the cartridge		
Spark				Clean - adjust the electrodes	Replace	Replace if used too much	

### AK60 - AH75

Element	Before each cutting	After the 50 first hours	Every 200 hours	Periodically	Observation
Cooling system	Cleaning around the muffler			Check and clean	
Transmission		Drain the oil	Drain the oil	Check oil level in hydrostatic transmission box and ensure cooling not impeded by grass or dust deposits	

The best maintenance consists of regular cleaning of the brush-cutter after each use (cutter housing, wheels, transmission).

# 11 • STANDARD REPAIRS - PROBLEMS AND REMEDIES

Most operating problems are due to incorrect handling, poor use of the brush-cutter or the lack of normal recommended maintenance. The following table describes simple methods of determining a few malfunctions and correcting them. If the problem persists, we recommend that you contact one of our approved ETESIA dealers (list on request to ETESIA - 67165 WISSEMBOURG Cedex - France).

ANORMAL OPERATION	PROBABLE CAUSE	REMEDY
The engine does not start - Insufficient compression	The piston, the cylinder, the rings, the valves or the cylinder head seal are defective	Contact an approved ETESIA service engineer
	The spark plug is loose Loose cylinder head screw	Tighten correctly
- Excess petrol	The motor has flooded	Close the petrol tap, remove the spark plug and dry the motor out by pulling on the starter
	No fuel in the combustion chamber	No fuel in the carburettor The fuel cock is closed Defective petrol intake Defective carburettor
Spark plug covered in fuel	Fuel/air mixture is too rich	Dry the motor out by pulling on the starter
	Blocked air filter	Clean
	Defective carburettor	Contact an approved ETESIA service engineer
	Incorrect type of fuel Contaminated fuel Water in the fuel	Replace the petrol
No spark or a poor spark	Defective spark plug	Replace the spark plug
	Defective distributor coil	Contact an approved ETESIA service engineer
Engine lacking in power - Engine overheats	Blocked air filter	Clean
	Blocked cooling grille	Clean
	Insufficient engine oil	Top up or change the oil
	Oil surplus	Remove the excess with a syringe
	Carbon deposits in the combustion chamber	Contact an approved ETESIA service engineer
Defective starter unit	Insufficient ventilation around the engine	Clean
	Snapped cord or broken return spring	Contact an approved ETESIA service engineer
Uneven running, strong vibrations	Blade balance	Rebalance or replace the blade
	Cutting blade loose	Tighten the attaching screws
	Coupling washer defective	Have replaced
Poor cutting	Blade mounted upside down	Refit with blade surfaces facing the engine
	Blunt blade	Sharpen or change
	Blade not turning in a horizontal plane	Change the blade
	Wrong choice of cutting height	Match the cutting height to the working conditions
	Advance too fast	Select a lower speed
The brush-cutter is difficult to engage in gear or disengage	Too low motor speed	Place throttle in the maximum position
	Wrong adjusted or stretched clutch cable	Contact an approved ETESIA service engineer
The motor speed does not increase	Worn belt	Have it changed by an approved ETESIA service engineer
	Faulty regulator	Contact an approved ETESIA service engineer

If this check up does not solve the problem, call your approved ETESIA dealer.



**IMPORTANT :** Only use ETESIA parts as replacements. The quality of the work, the life of the brush-cutter and your safety depend on it.

In addition to risks incurred by the user, the use of parts other than the manufacturer's will result in the cancellation of the warranty for any damage caused. ETESIA refuse to accept responsibility for accidents due to the use of parts not coming from the manufacturer.

## 12• WARRANTY

### DEFINITIONS

- Dealer, importer = distributor linked to ETESIA by an agreement (dealership or importer contract). The dealer and the importer are in charge of selling and servicing ETESIA machines.
- User, buyer = physical or moral person, company, collectivity or association having bought legally a machine new or second hand from a dealer.
- Domestic use = use of a machine on a private ground. Machine is owned by the user and just use to clear its private piece of ground (main or secondary residence).
- Professional use = use of an ETESIA machine, in exchange of money or not, on public areas to maintain companies or institutions like : hospitals, associations,...or on private fields being owned by a third person.
- Wear parts/consumable parts : parts needing to be changed inevitably to enable an optimal normal use of the machine.
- Normal use = use of the machine according to all instructions mentioned in the instruction book (including safety and maintenance).

### GENERAL WARRANTY CONDITIONS

- In addition to the legal warranty, ETESIA offers a contractual warranty. The ETESIA warranty concerns the exchange of parts free of charge in case of material, production or conception fault. This warranty applies to the product as he leave ETESIA production line.
- The delivery company is only responsible in case of transport damage. It is however the addresse responsibility when damages occurs during transport to mention reserves on the delivery note when receiving the goods and to inform ETESIA within 48H by registered letter.
- The instruction book delivered with every machine contents all information regarding machines use. Any different use from the one described in the instruction book can be dangerous for the user and reduce machine life. In such cases, ETESIA can not be held responsible.

### CONTRACTUAL WARRANTY

- ETESIA offers, in addition to the statutory warranty, in particular that covering hidden and latent defects and the guarantee of conformity of the product with the contract due by the vendor to the consumer, a contractual warranty:

The ETESIA contractual warranty is allowed for 2 years in professional use and for 3 years on domestic use (warranty period starting the first day when the machine is purchased by the user). This warranty is valid if :

- 1) Instructions from the instructions book have been respected.
- 2) The warranty card has been returned to ETESIA immediately after the machine purchase or completed on the extranet site.
- 3) Strict respect of or revisions as defined in the maintenance table of the user instructions is required.
- 4) To request a repair under warranty, the buyer must contact the ETESIA dealer. Should it not be possible, he could contact ETESIA who will propose an alternative solution.
- 5) Any suspected failure by way of a defect within the framework of the contractual warranty must be presented by an approved dealer. Only repairs done by ETESIA dealers workshops can be taken under warranty.
- 6) Any material, production or conception fault recognized by ETESIA as such will be eligible for warranty (parts and labour). It will therefore be paid back to the dealer according to charge scale mentioned in the agreement.

It is the dealers responsibility to make sure that the end user does receive the complete warranty allowed by ETESIA. Should ETESIA not recognize any fault, the dealer will be held responsible. ETESIA reserves the right to cancel the decision with no compensation or warning.

- 7) Any intervention done within warranty time, in particular in case of parts exchanged, will not give right to any new warranty period.
- 8) In case of parts exchanged under warranty, ETESIA reserves the right to use either new or second hand parts. Parts replaced can be requested to be returned at any time by ETESIA. Should ETESIA not receive these part(s), a warranty claim would automatically be rejected.
- 9) This warranty however does not cover : parts damaged during a repair action ; machines not having been serviced according to the repair schedule mentioned in the instruction book ; parts with normal wear.

Please find a list (not complete) of wearing parts: spark plugs, filters, exhaust, seals, membranes, blades, blade coupling parts, belts, clutches, batteries, battery electrolytes, control cables, sheath, fuel pipes, durits, cooling liquid, hydraulic and lubrication liquids, fuel, seat, bonnets, grassbox, material grassbox frame, mudguards, pedal covers, running board cover, anti scalp kit, roll axle...

- 10) Warranty right is cancelled in the following cases:
  - a) Damages due to non respect of safety, maintenance use and storage instructions. ETESIA will not be held responsible, legally in particular, for damages resulting from other uses than the ones described in the instruction book.
  - b) Damages due to accident or collision.
  - c) Damages due to a modification of the original machine or use of non original spare parts.
  - d) Damages to machines not having been maintained by the ETESIA dealer network.
- 11) In case of owner change, the outstanding warranty period can be transferred to the new owner. However to enable this transfer a written request need to be sent to the ETESIA after sales department. This request needs to attest as well that the new end user has received the instruction book for the machine as well as the warranty terms.
- 12) ETESIA reserves the right to check that preliminary conditions for warranty have been respected by the buyer.
- 13) When a warranty application is requested, ETESIA will deliver the parts as soon as possible. However an immediate delivery can not be requested.

A delay in delivery would in no case give right to compensation or to warranty extension.
- 14) Any additional claims to ETESIA is excluded.
- 15) In the event of a dispute over a warranty claim, the only competent court will be the one indicated on the distribution contract between ETESIA and the approved dealer in question.

### IMPORTANT NOTE :

As soon as a machine purchase takes place, the warranty cards needs to be :

- completed, signed and sent back to

**ETESIA – WARRANTY SERVICE**  
**67165 WISSEMBOURG CEDEX FRANCE**

- or completed by your dealer on line on the extranet.

These contractual guarantees are in addition to the legal warranty against hidden and latent defects and the guarantee of conformity of the contract by the seller to the consumer.



# EC DECLARATION OF CONFORMITY

In accordance with Directive 2006/42/EC

We,

**ETESIA**

13, rue de l'Industrie, 67165 WISSEMBOURG CEDEX

declare under our responsibility that the petrol brush-cutter, type AK60 - AH75 to which this declaration refers, fulfil all the relevant terms of directive 2006/42/EC applicable to them as well as to the provisions of all other applicable European directives :

- **2000/14/EC (from 08/05/00)**      Sound emissions in the environment by equipment intended for use outside buildings
- **2014/30/UE (from 26/02/14)**      Electromagnetic compatibility

And guarantee that petrol brush-cutter, type AK60 - AH75 meet the requirements of Directive 2000/14/EC regarding noise emissions in the environment, and are subject to the internal production control procedure (Annex V).

Mr Freddy Schmitt,  
13, rue de l'industrie 67165 Wissembourg CEDEX  
is the person authorized to constitute the technical file.  
Assessment of conformity in-house inspection of machine manufacture according to Annex VIII of directive 2006/42/EC.

Model :

CE

Production year

Serial number :

Done in Wissembourg, the 05.03.2019  
Mr. Francis NEFF



The President

Due to Etesia's continual improvement policy, ETESIA reserves the right to modify specifications, text and pictures without prior notice.

ETESIA SAS - F -  
67165 WISSEMBOURG CEDEX -  
Strasbourg Trade & Commerce Register B343 510 996



Stamp  
here  
please

ETESIA

SERVICE GARANTIE

13 rue de l'Industrie  
67165 WISSEMBOURG CEDEX  
France



